



## EXTRA INSTRUCTIONS INFORMATION!



### HARDWARE LIST / LISTE DE MATÉRIEL

#### ROUND HEAD SCREW

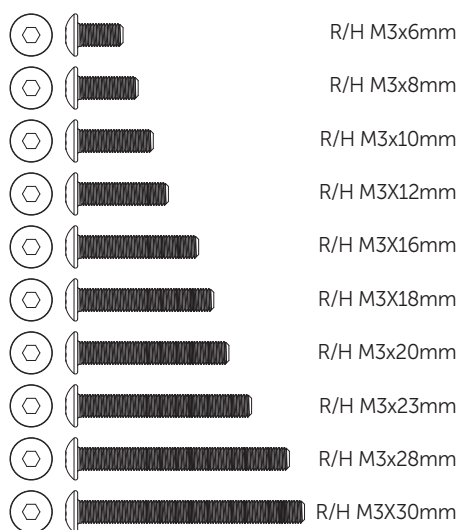
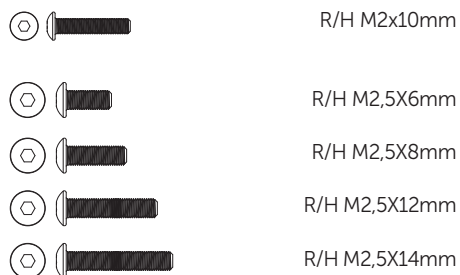

#### FLAT HEAD SCREW



#### SET SCREW

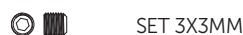

#### CAP HEAD SCREW

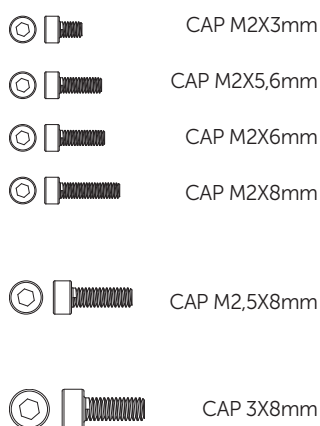

#### NYLON LOCK NUTS

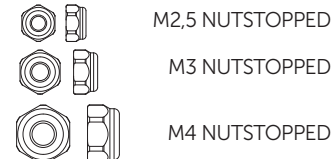

#### WASHERS

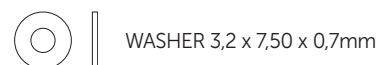

#### DETAIL ICON

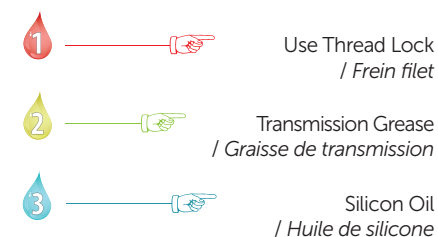

### ERRATUM

Please replace the following steps in order to assemble better you kit!  
Remplacer les étapes suivantes afin d'assembler correctement votre kit !

#### BAG A-02

WHEEL-DRIVE  
ASSEMBLY (F&R)

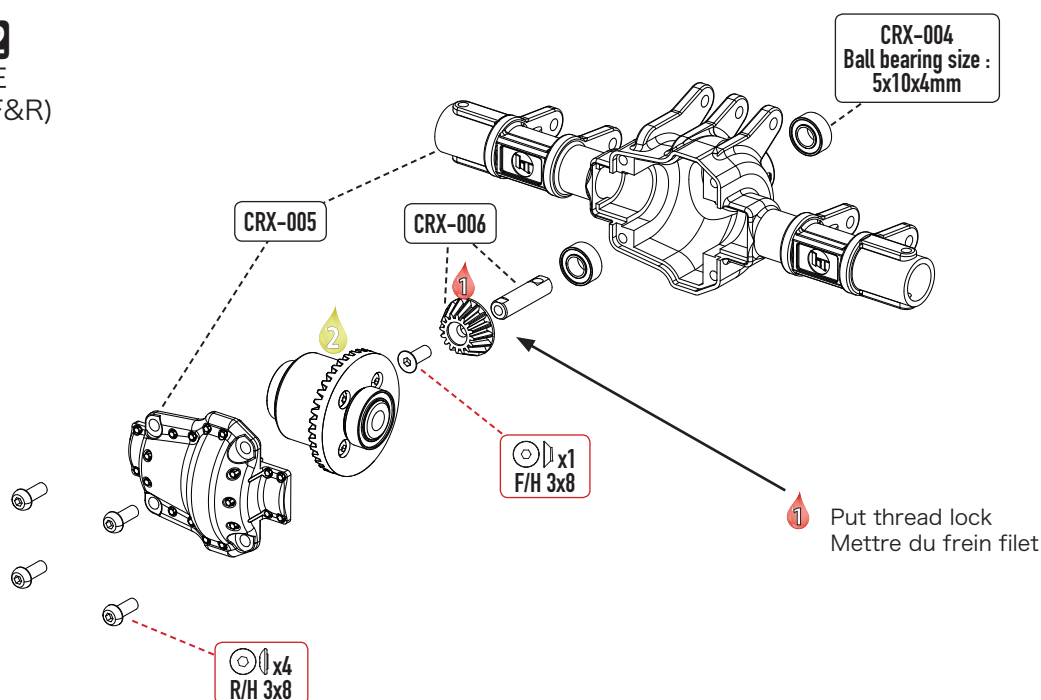



## EXTRA INSTRUCTION INFORMATION!



### BAG G-01

#### LEFT & RIGHT ROCK SLIDERS ASSEMBLY

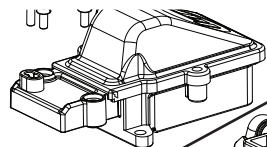
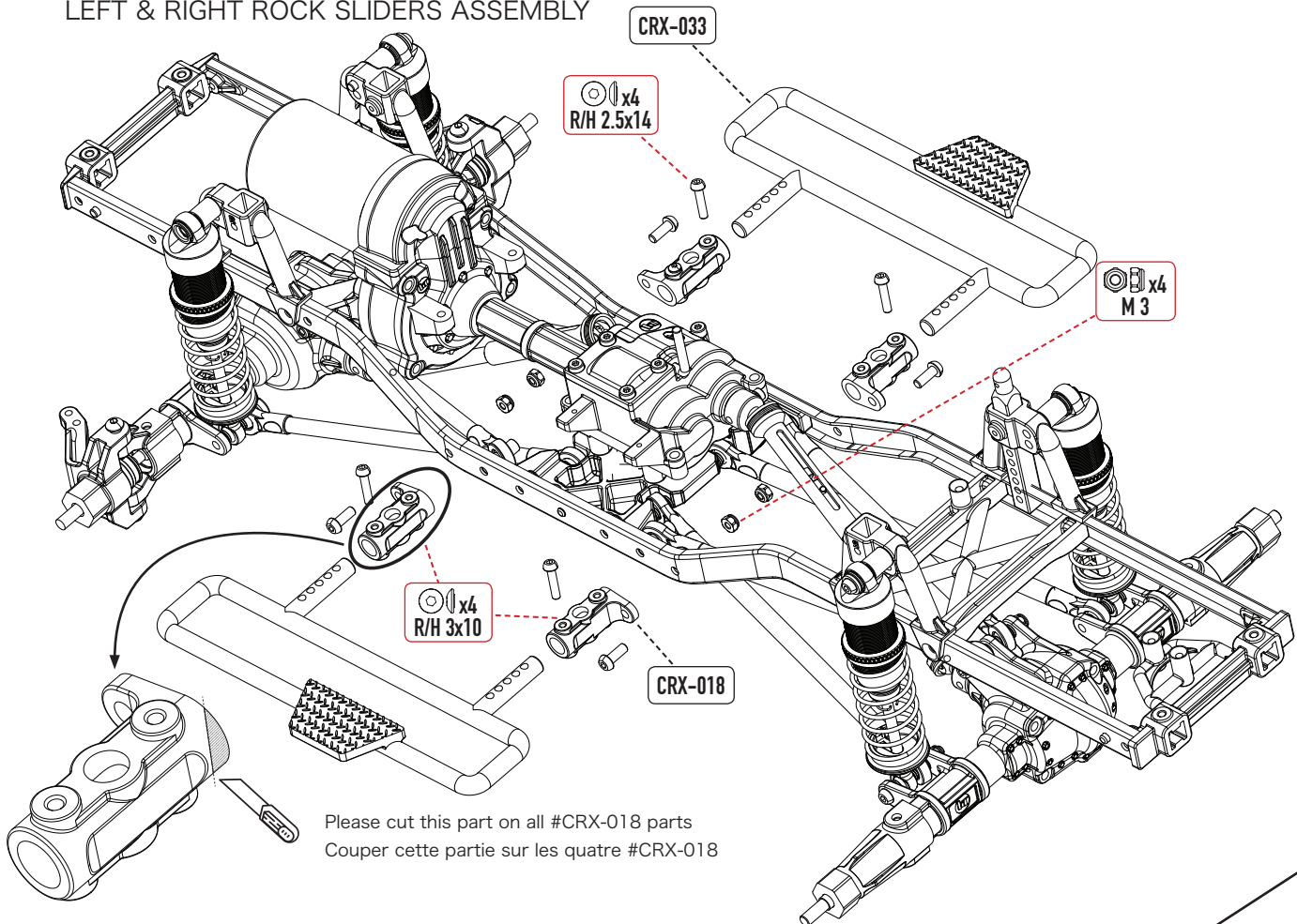

Please note correct screw position  
for assembly  
Sens correct de montage de la vis

### BAG G-02

#### BATTERY & ESC/RX PLATE HOLDER ASSEMBLY

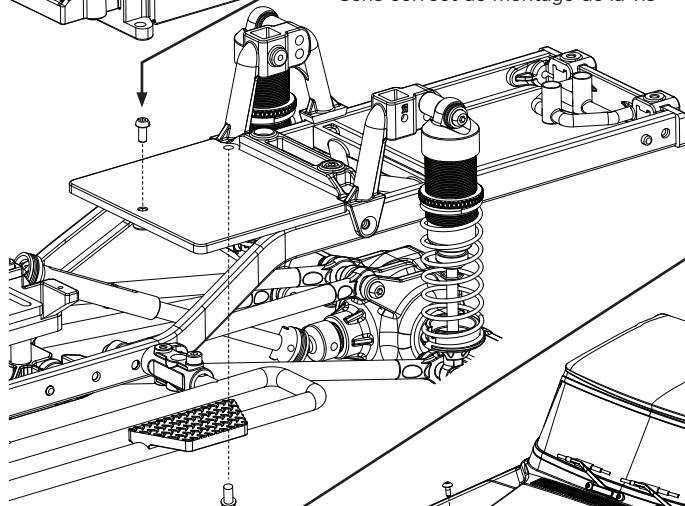

#### BODY & ACCESSORIES ASSEMBLY

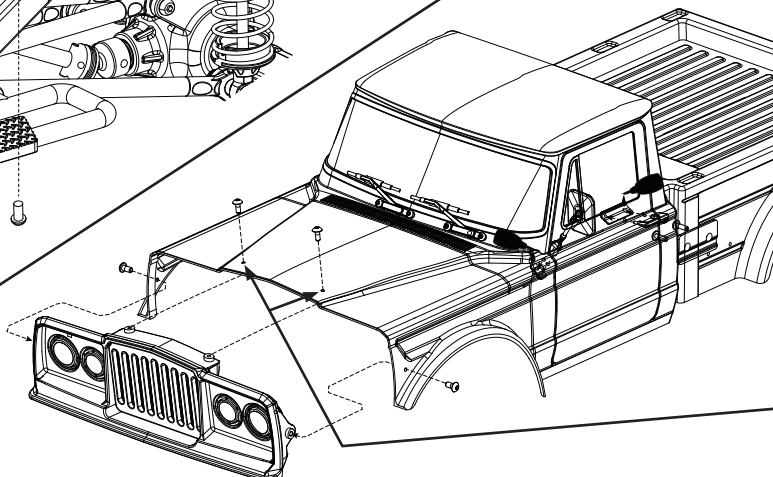

If PC body pre-holes don't match with the plastic parts screws pre-holes, please modify the position before drilling the body. You can also adjust the PC body cutting lines.

Si les indications de perçage de la carrosserie avec les pièces en plastique ne correspondent pas exactement, merci de bien vouloir modifier leur positionnement avant de percer la carrosserie. Vous pouvez également ajuster les découpes de la carrosserie pour faire correspondre les trous.