

MST
MAX SPEED TECHNOLOGY



GMAX OFF ROAD RTR
1/10 RC 4WD HIGH PERFORMANCE OFF ROAD CAR

WWW.RC-MST.COM

*SPECIFICATION ARE SUBJECT TO CHANGE WITHOUT NOTICE

**EXPLODED
MANUAL**

WHEELBASE : 242 / 252 / 267mm
WIDTH : 195mm
GEAR RATIO = 1:19 ~ 1:42.6
TIRE WIDTH / DIAMETER : 30x90mm



如需其他協助，請向原購買店家，或遙控模型店詢問！謝謝！

請於空曠或安全無虞的場所，使用本項產品。



※ Please refer to instruction of ESC performance.
電子變速器功能說明請參閱詳細說明書。

BUMPER

前保桿

M3×14 screw ×2
圓頭螺絲

M3×25 screw ×2
圓頭螺絲

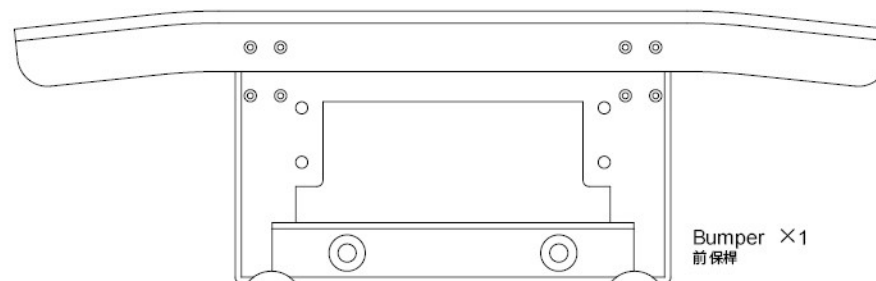

STEP 1 Attaching bumper
安裝前保桿

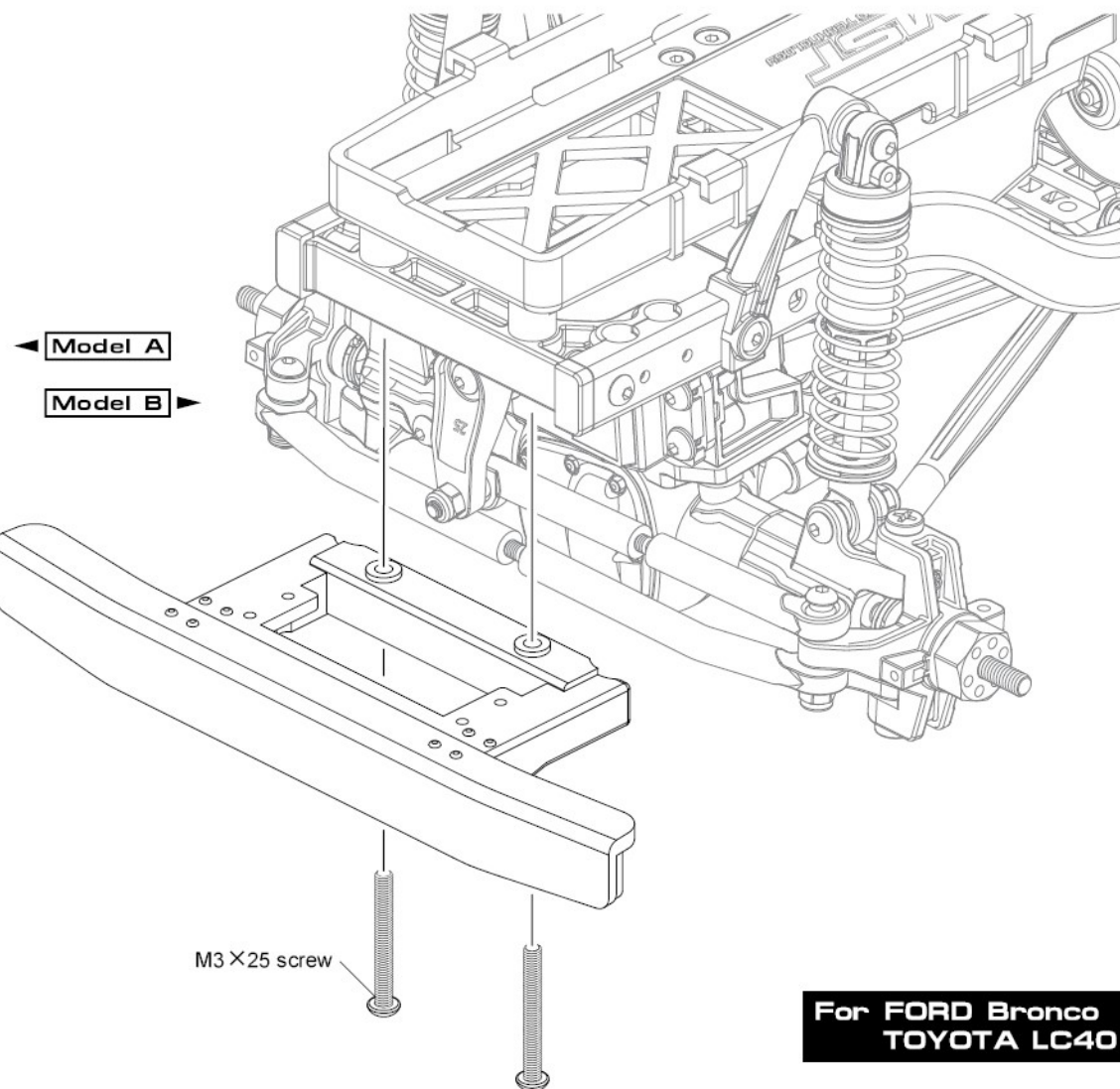
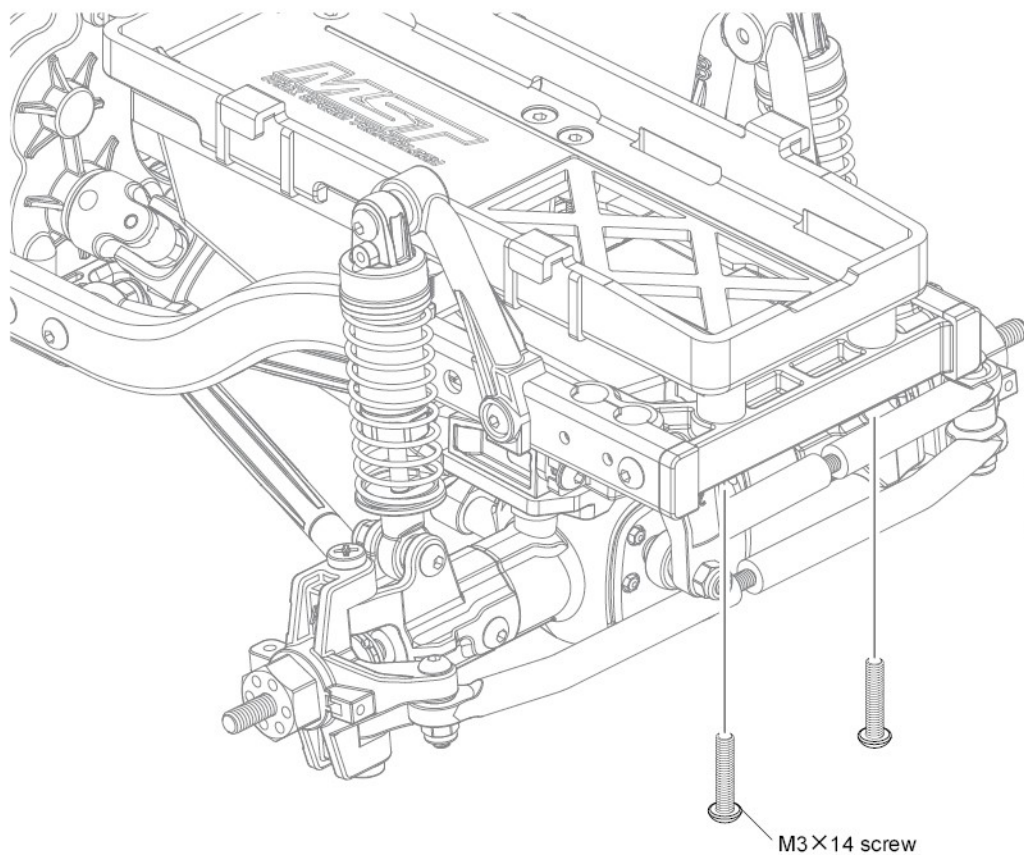

For M-BENZ Unimog 406
TOYOTA FJ

For FORD Bronco
TOYOTA LC40

WHEELS

輪胎

M4 flange nut ×4
凸緣螺帽

STEP 1 Attaching front wheels

安裝前輪

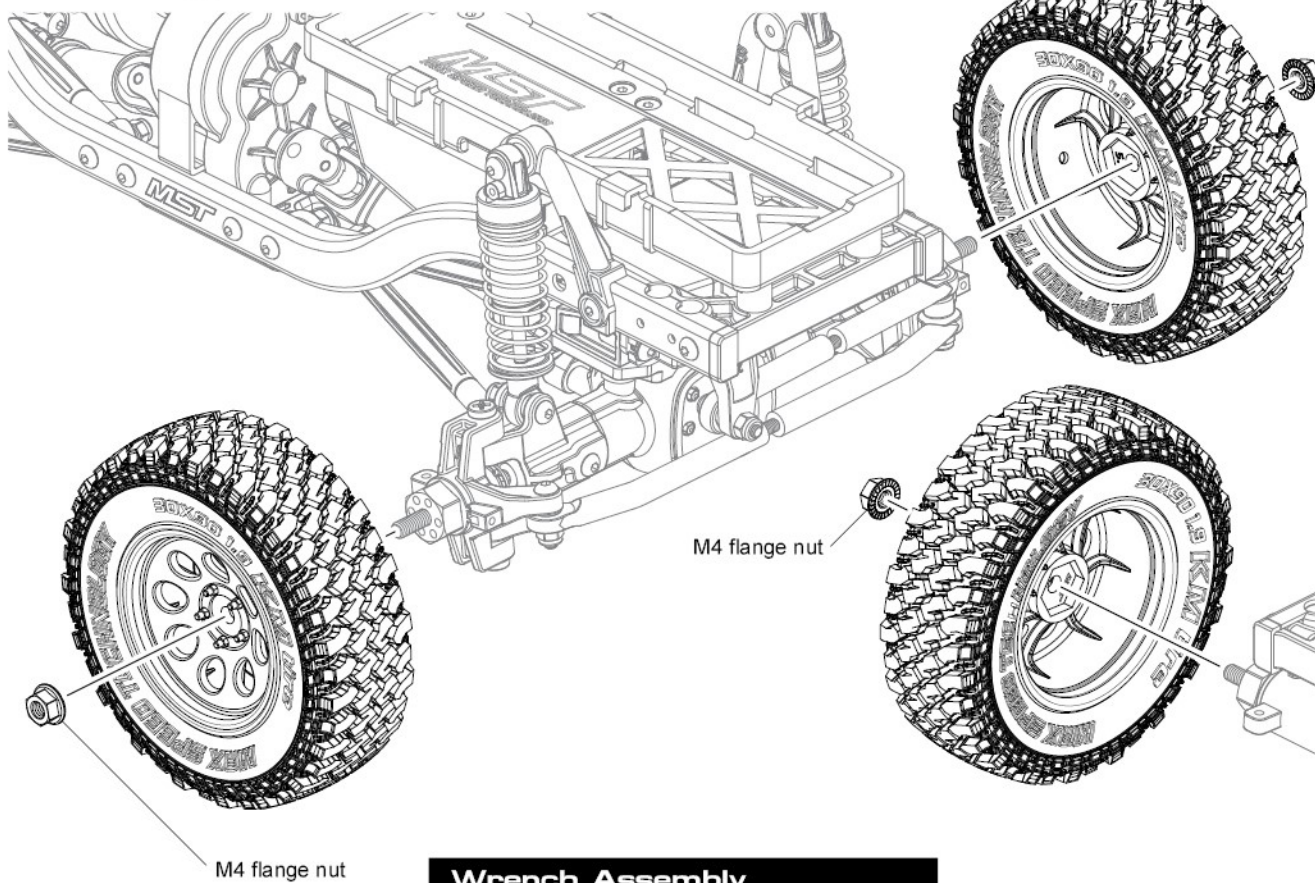

STEP 2 Attaching rear wheels

安裝後輪

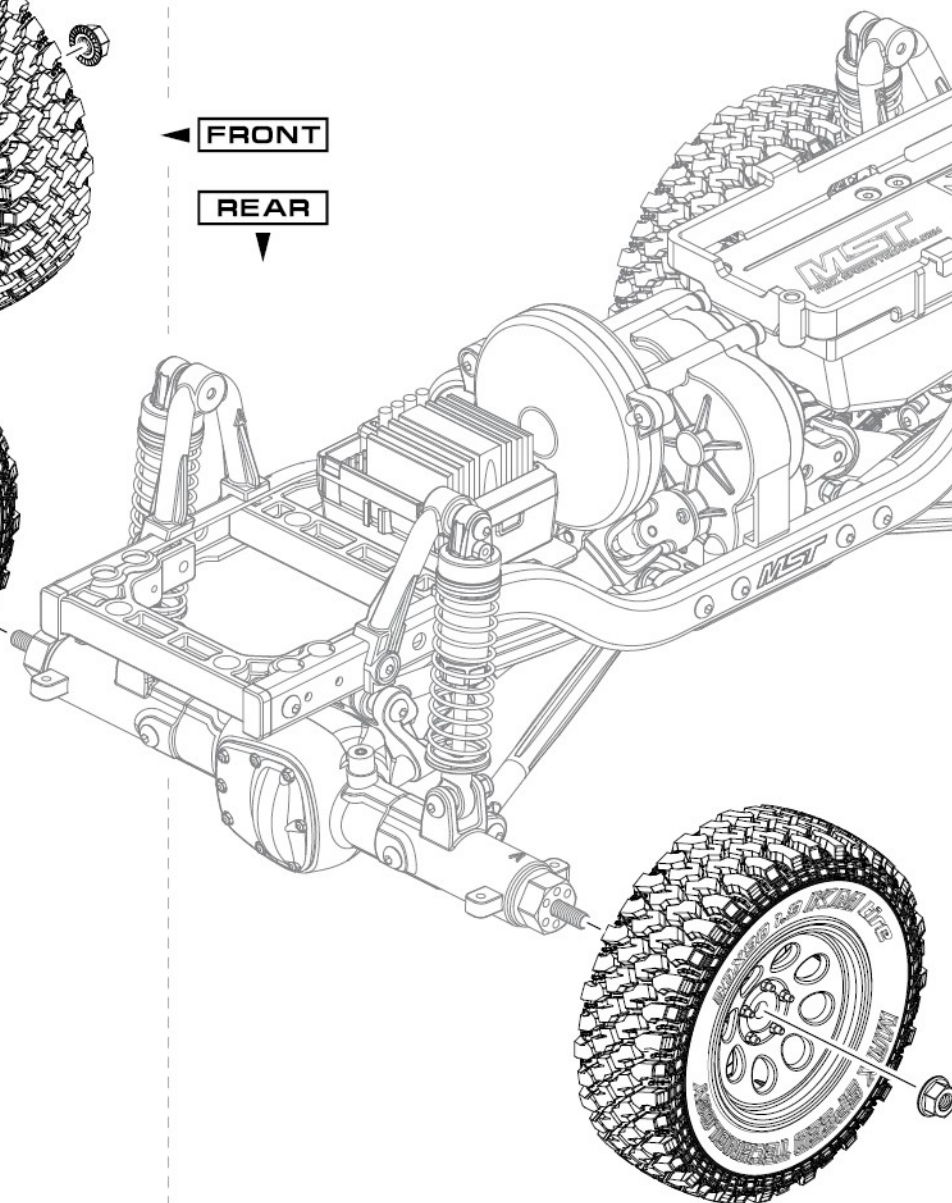

Wrench Assembly

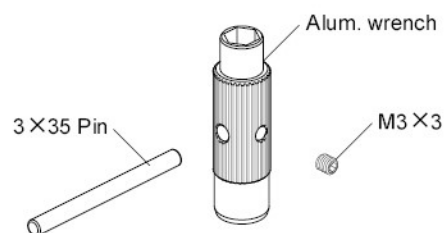

BODY MOUNTS

車殼固定座

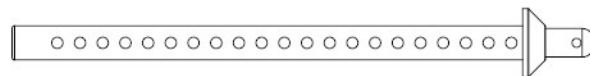
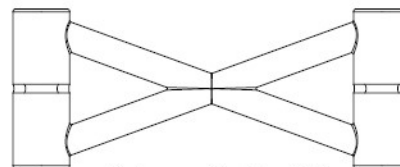
Body mount extension ×2
車殼延伸柱Body mount ×4
車殼支柱Body mount holder ×2
車殼支柱連接架R-clip ×5
R形扣M2×10 Screw ×6
圓頭螺絲STEP 1 Attaching body mounts
安裝車殼固定座

For J3, FORD Bronco, M-BENZ Unimog 406, TOYOTA FJ

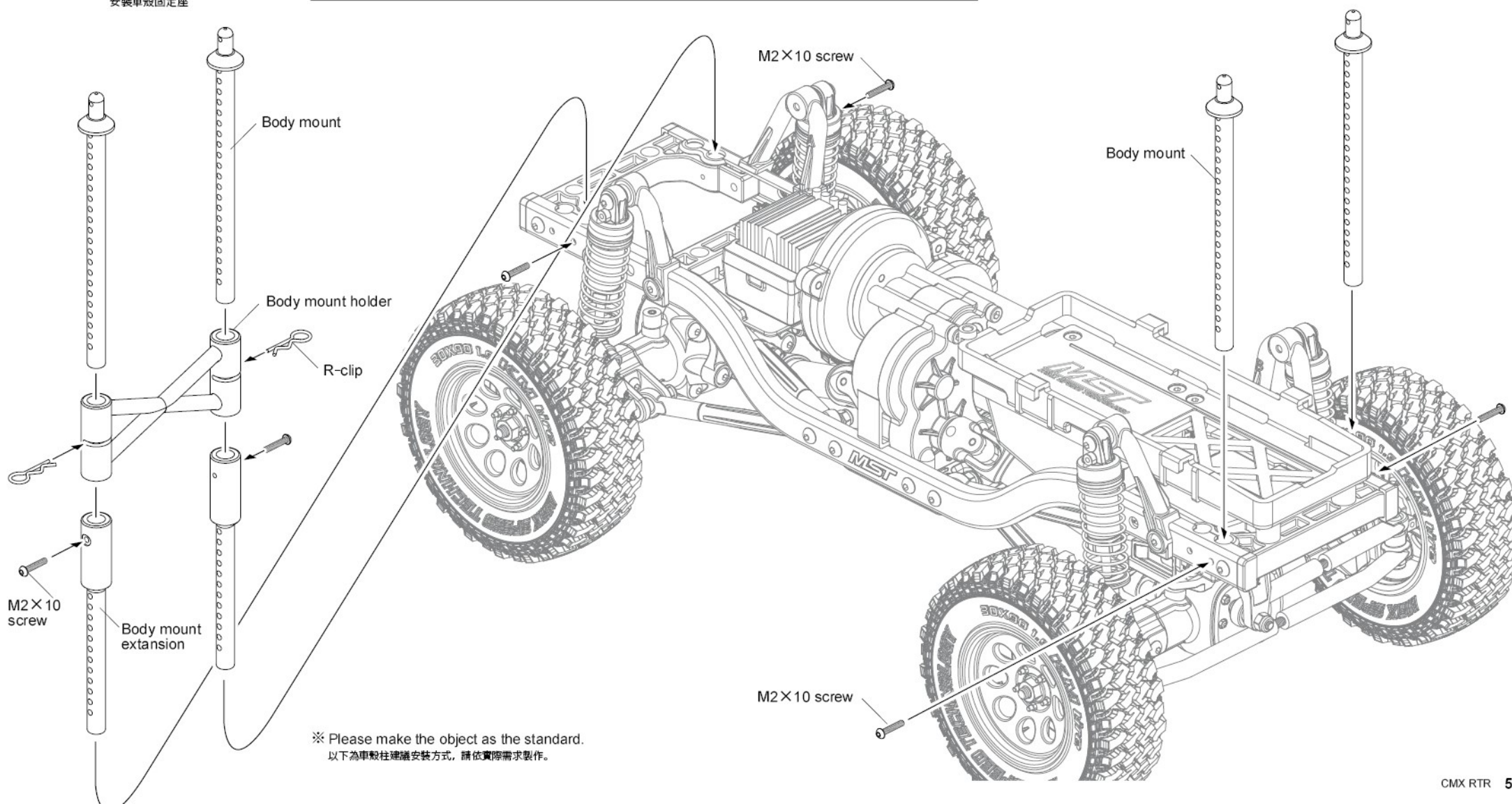

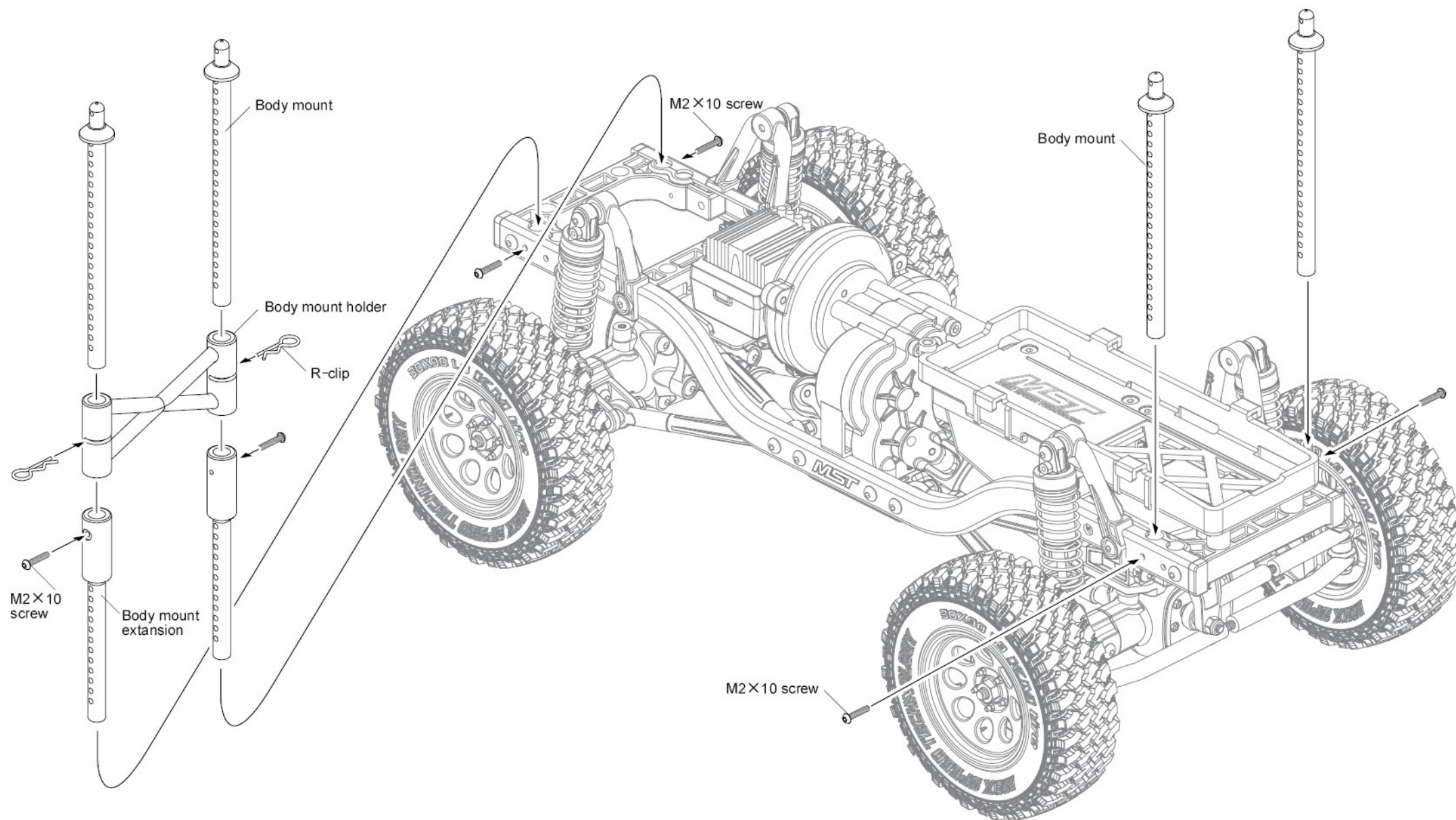
STEP 1 Attaching body mounts
安裝車殼固定座**For TOYOTA LC40**

※ Please make the object as the standard.
以下為車殼柱建議安裝方式，請依實際需求製作。

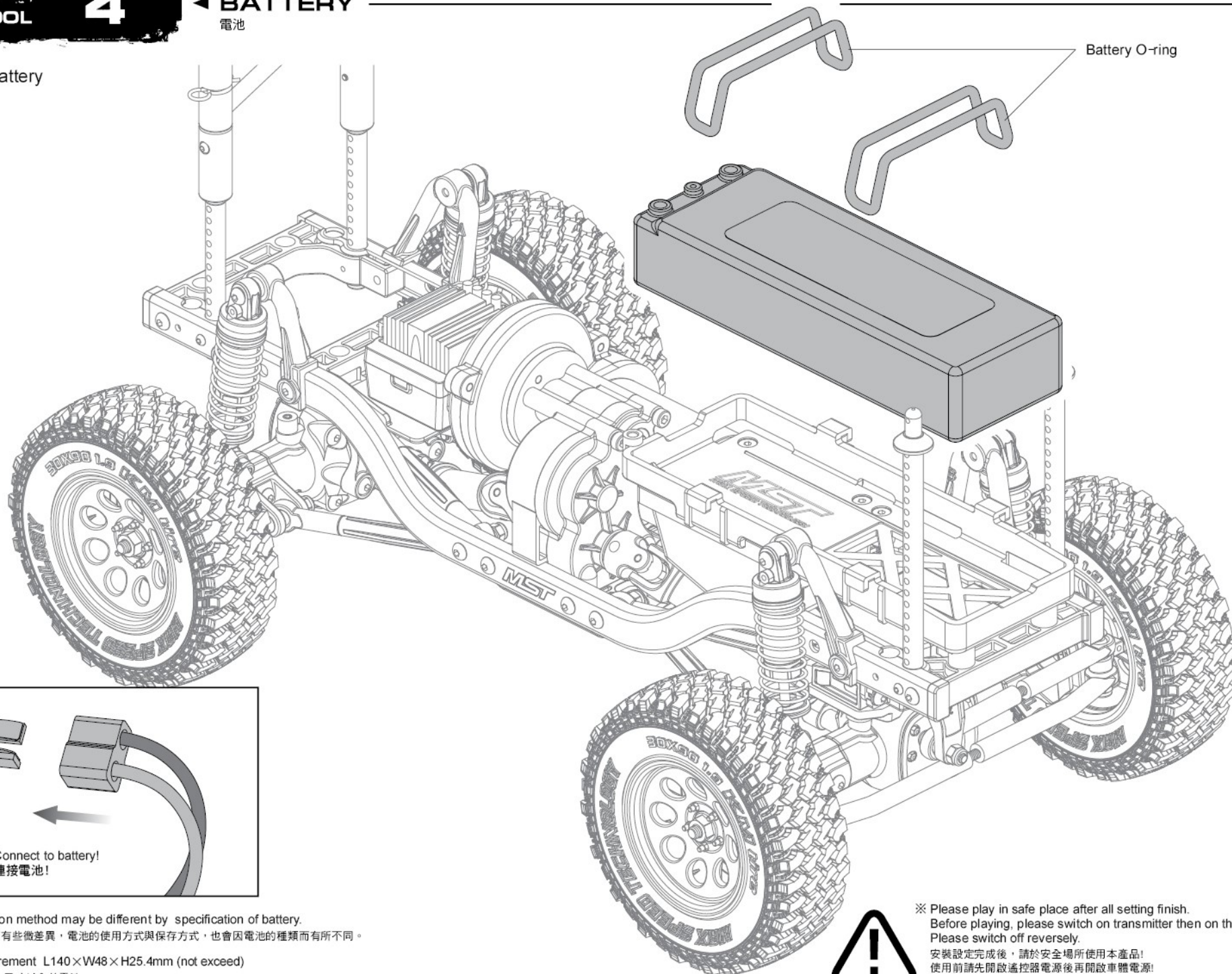
STEP 1 Attaching battery
安裝電池

Battery O-ring

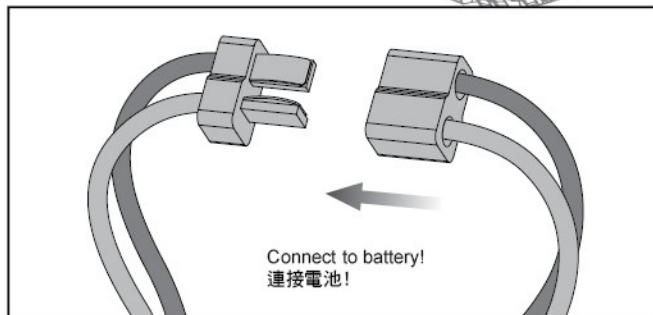

- ※ The assembly and conservation method may be different by specification of battery.
電池的安裝方式會因為廠牌規格而有些微差異，電池的使用方式與保存方式，也會因電池的種類而有所不同。
- ※ Recommended battery measurement L140×W48×H25.4mm (not exceed)
建議安裝長140×寬48×高25.4mm尺寸以內的電池。

- ※ Please play in safe place after all setting finish.
Before playing, please switch on transmitter then on the car.
Please switch off reversely.
安裝設定完成後，請於安全場所使用本產品！
使用前請先開啟遙控器電源後再開啟車體電源！
使用後請反向操作關閉！







For 242mm wheelbase

Front upper link

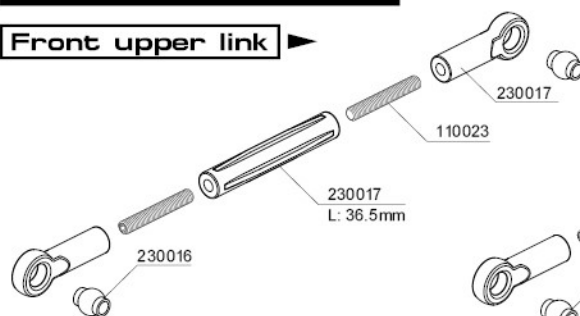

Front lower link

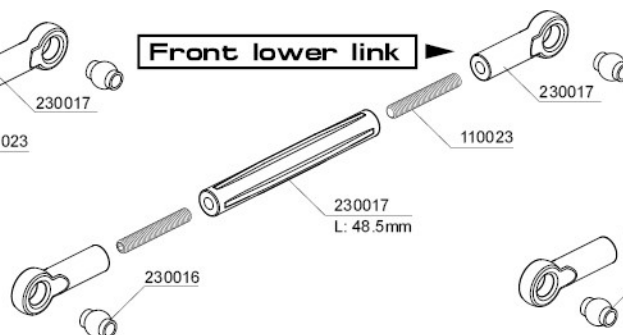

Rear upper link

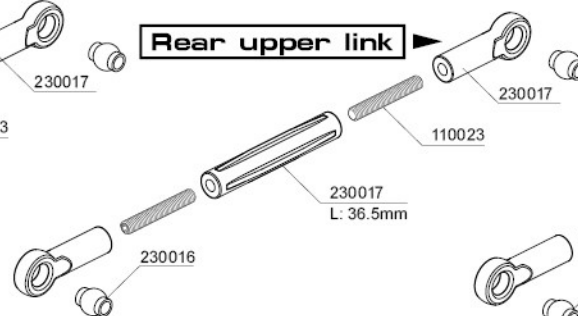

Rear lower link

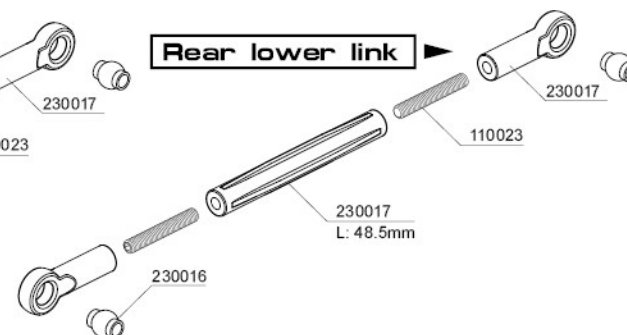

For 252mm wheelbase

Front upper link

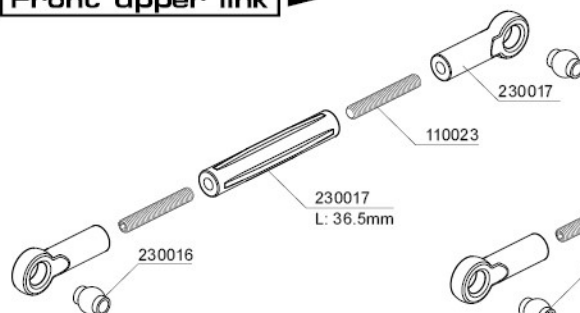

Front lower link

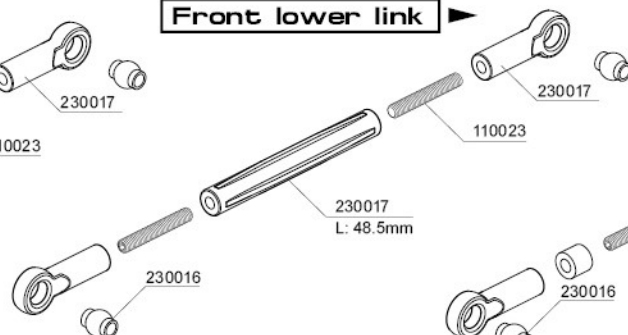

Rear upper link

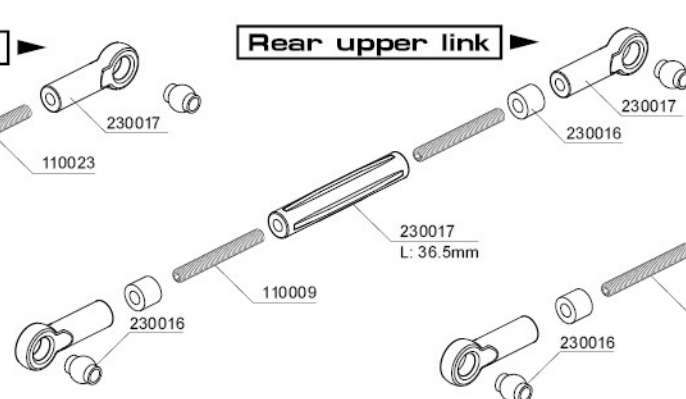

Rear lower link

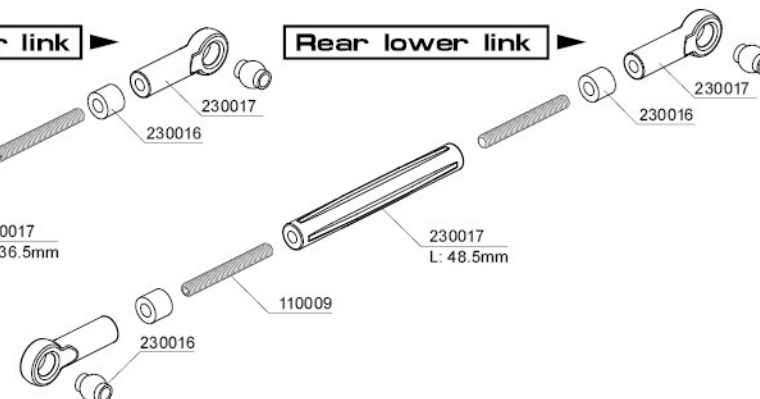

For 267mm wheelbase

Front upper link

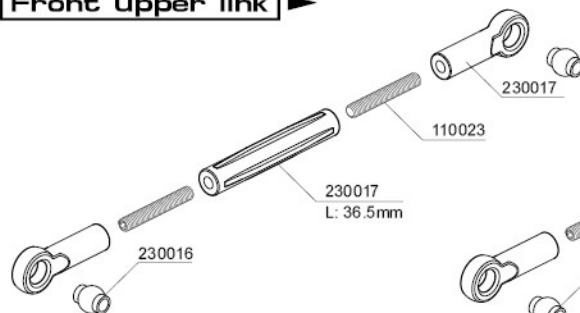

Front lower link

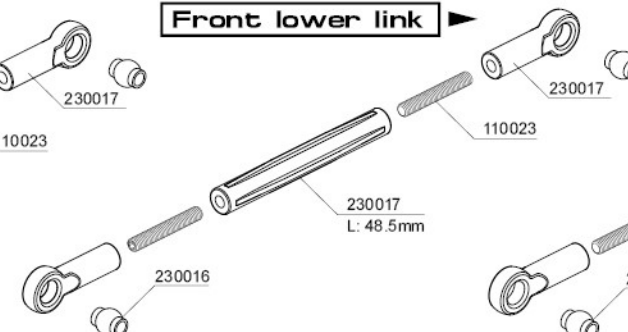

Rear upper link

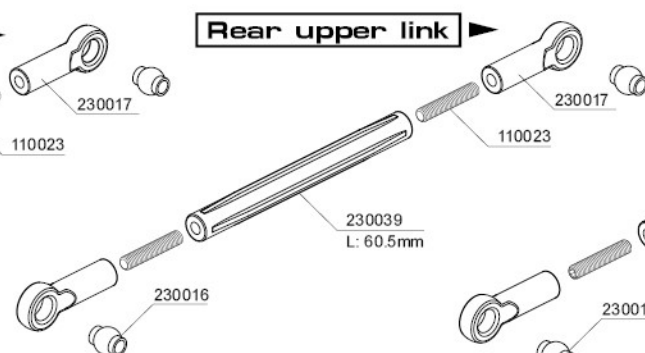

Rear lower link

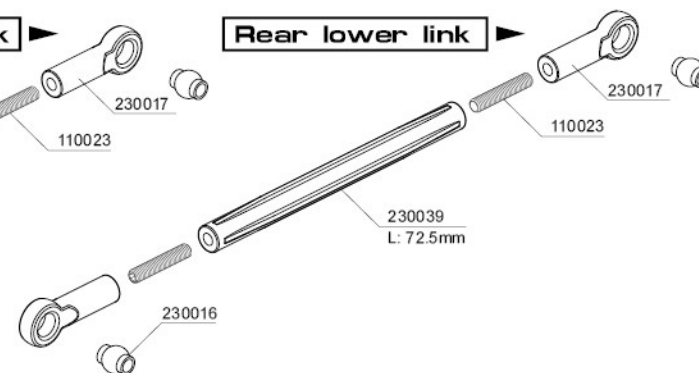

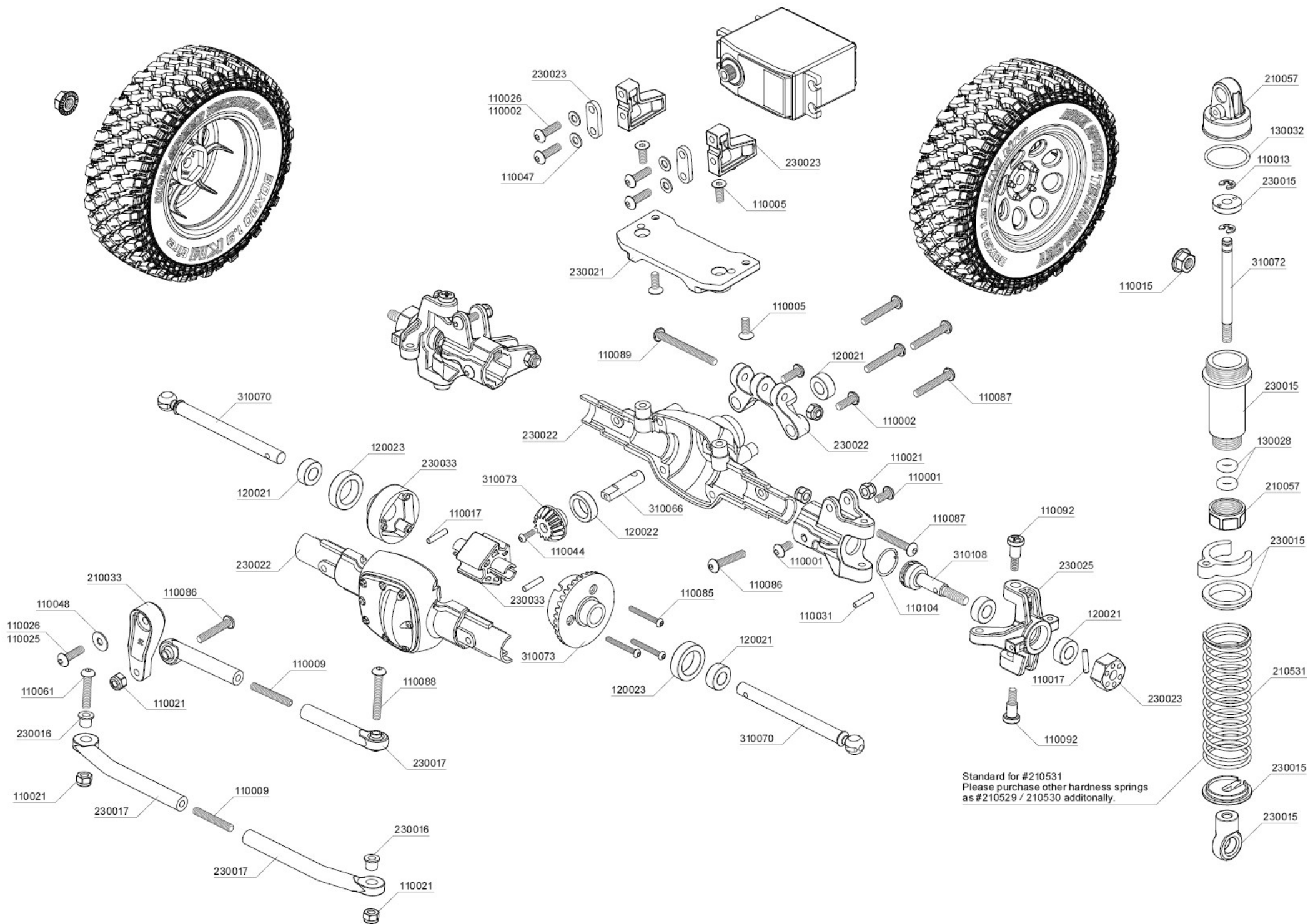

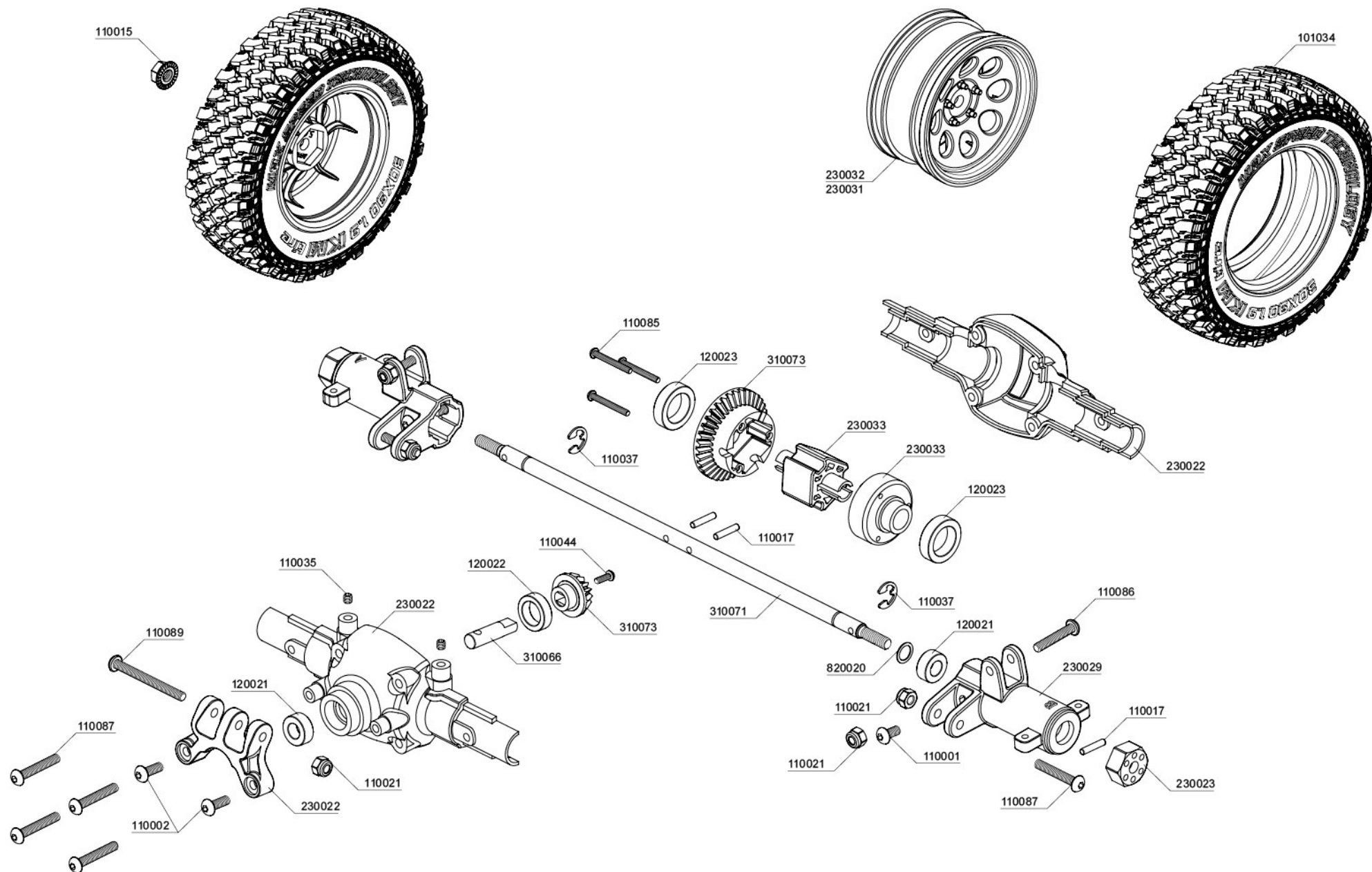

PARTS

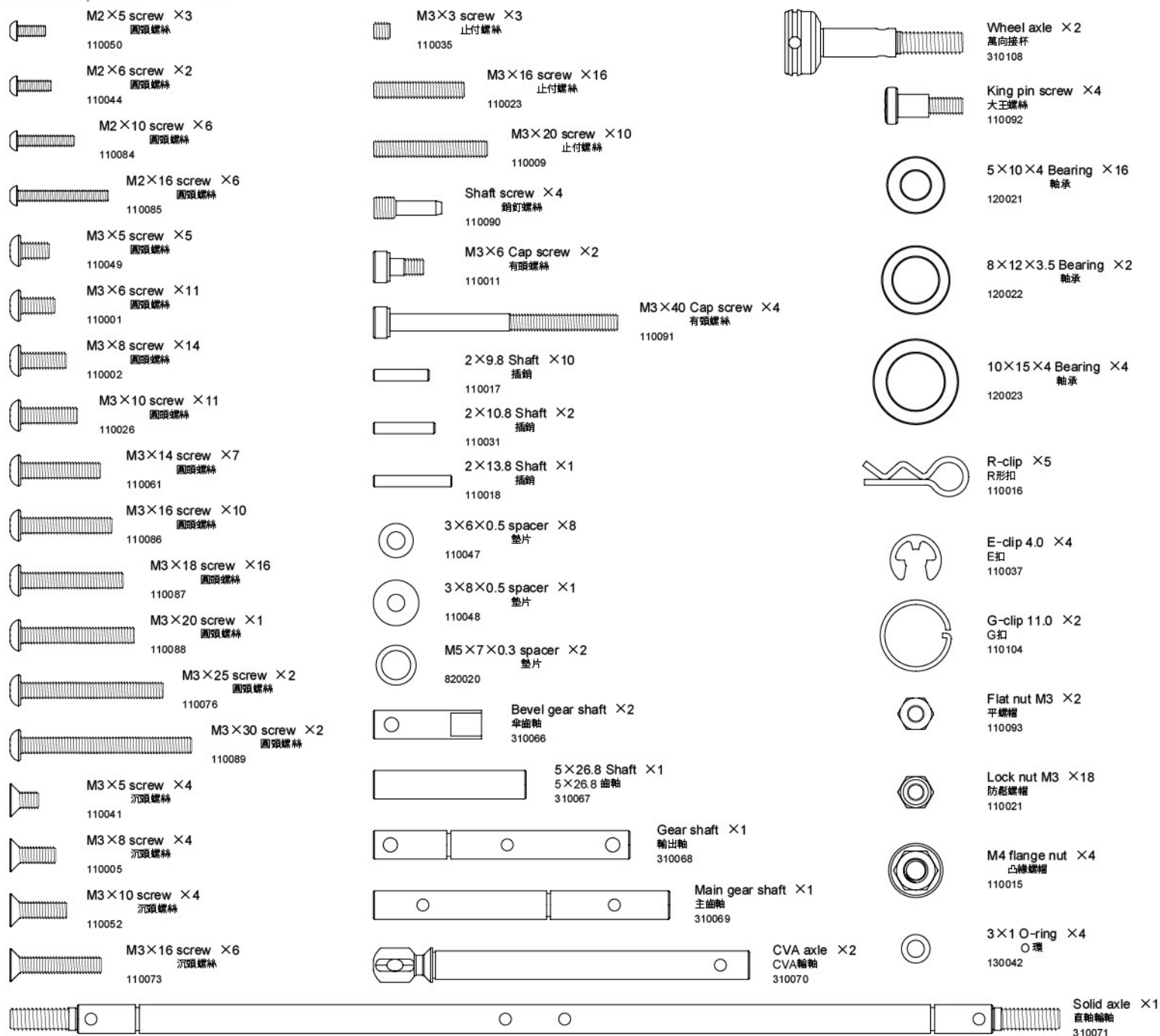

CMX Deceleration gear set
CMX 減速齒組
230014

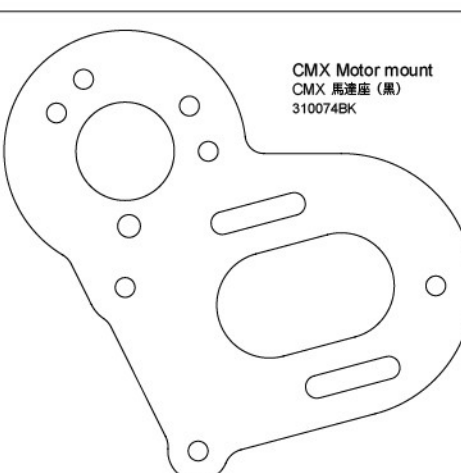
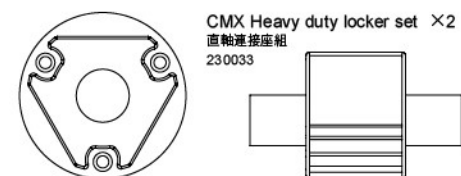
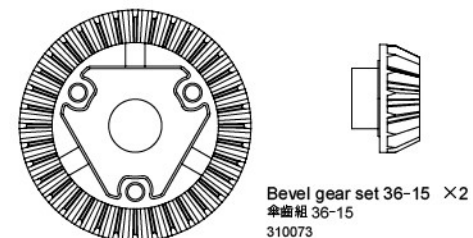
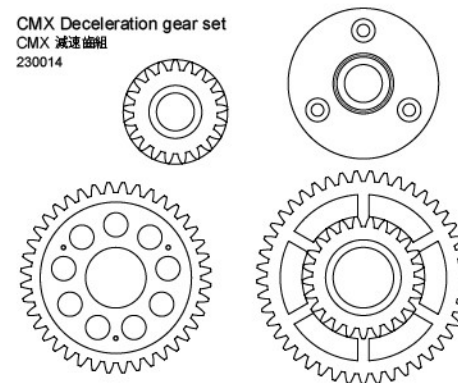

PARTS

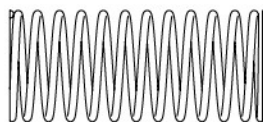

Coil spring 45mm (hard)(silver) ×4
避震彈簧 45mm (硬)(銀)
210529

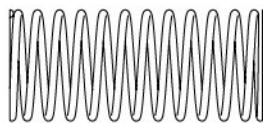

Coil spring 45mm (medium)(gold) ×4
避震彈簧 45mm (中)(金)
210530

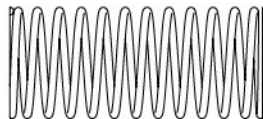

Coil spring 45mm (soft)(red) ×4
避震彈簧 45mm (軟)(紅)
210531



Piston rod ×4
避震軸心
310072



E-clip ×8
E扣
110013



Damper cylinder ×4
避震筒身
230015



Piston ×4
活塞
230015

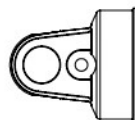

Cylinder cap ×4
避震器上蓋
210057



Spring spacer ×4
彈簧調整扣 1mm
230015



Rod guide cap ×4
避震器下蓋
210057



Spring spacer ×4
彈簧調整扣 2mm
230015



Damper retainer ×4
避震器彈簧座
230015



Spring spacer ×4
彈簧調整扣 4mm
230015

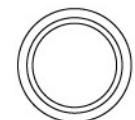

Spring holder ×4
彈簧托環
230015



Damper adjuster ×4
避震器拉桿
230015

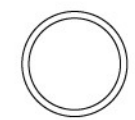

10.8×0.9 O-ring ×4
O環
130032



Damper O-ring P3 ×8
避震器O環
130028

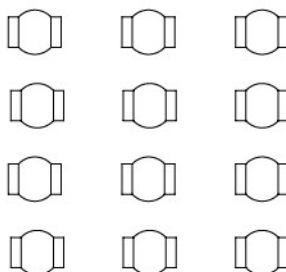
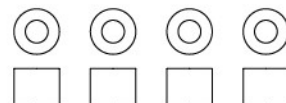

CMX Ball connector set ×2
CMX 球頭組
230016

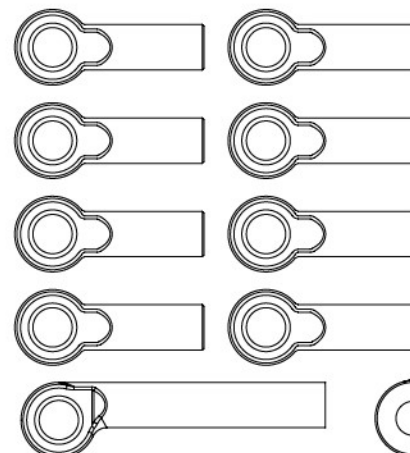

CMX Link set ×2
CMX 拉桿組
230017

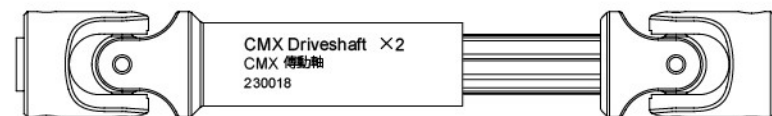

CMX Driveshaft ×2
CMX 傳動軸
230018

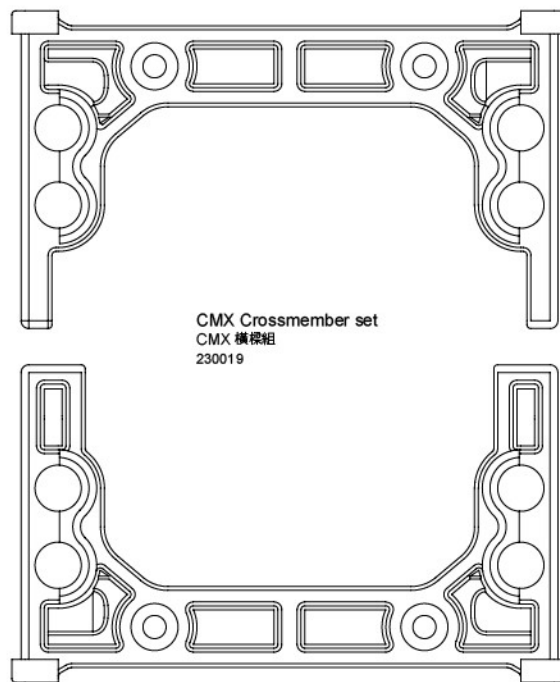

CMX Crossmember set
CMX 橫樑組
230019

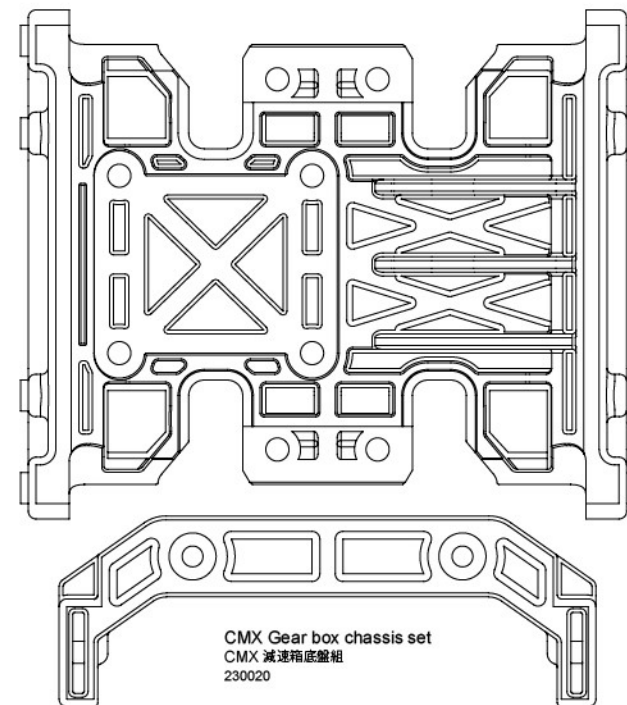

CMX Gear box chassis set
CMX 減速箱底盤組
230020

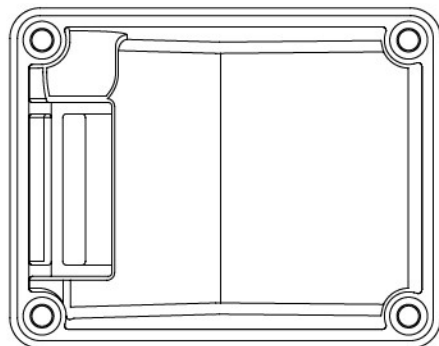
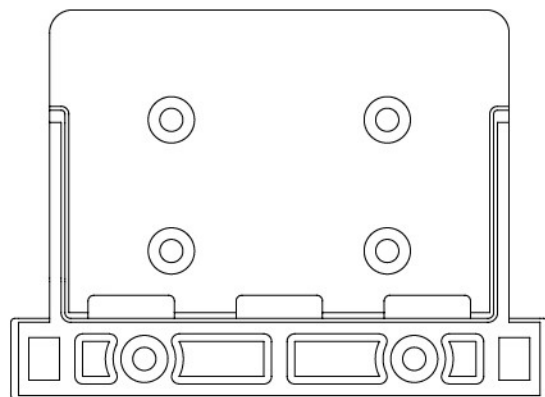

CMX Receiver case set
CMX 接收機盒組
230021

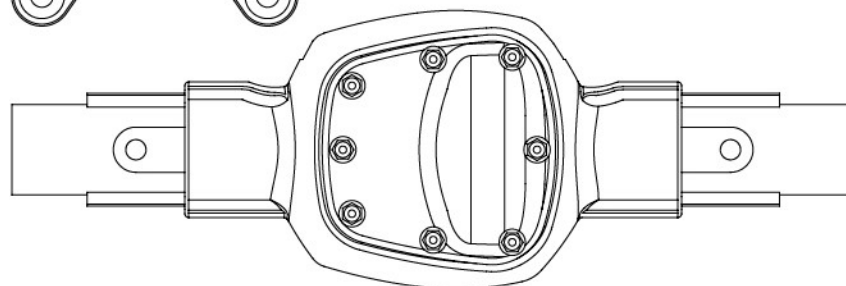
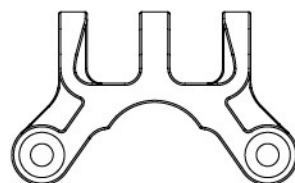
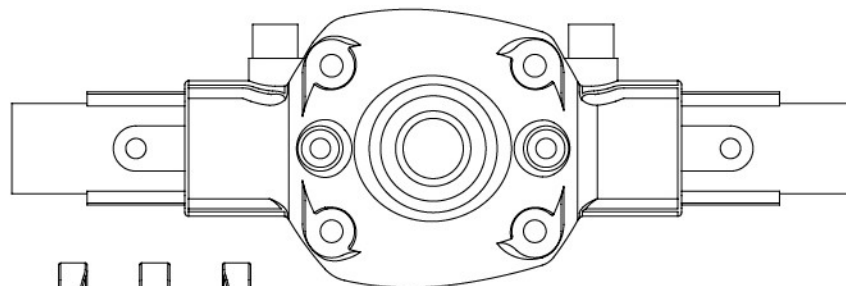

CMX Axle cover ×2
CMX 車軸殼
230022

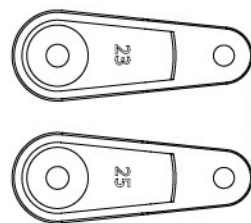

Servo horn set (long) (23T/25T)
伺服機舵片組-長 (23T/25T)
210033

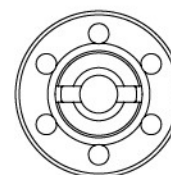

Spur gear holder
齒盤座
230034

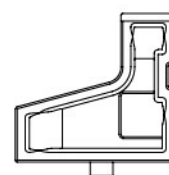
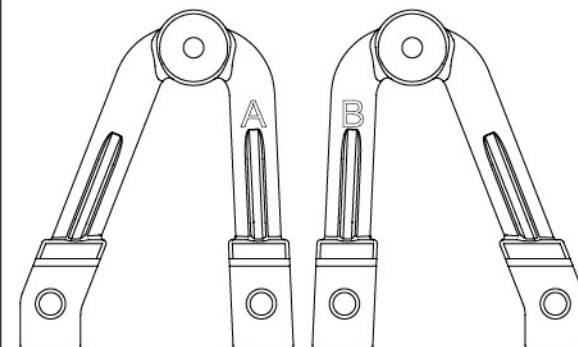

CMX Damper stay set ×2
CMX 避震架組
230023

CMX Car body post set ×2
CMX 車殼支柱組
230026

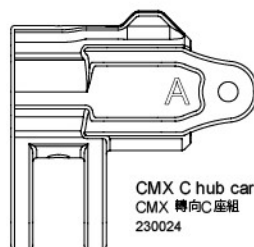
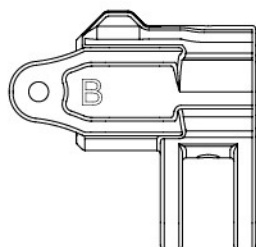
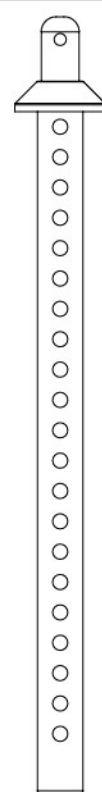
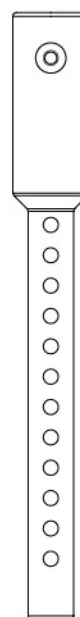
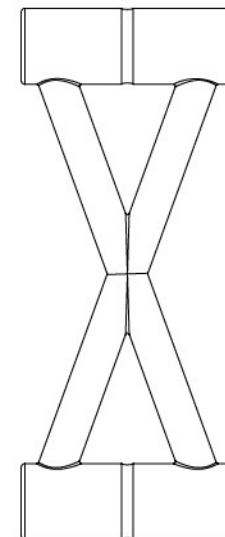

CMX C hub carrier set
CMX 轉向C座組
230024

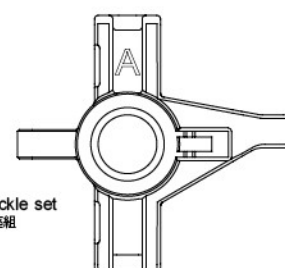
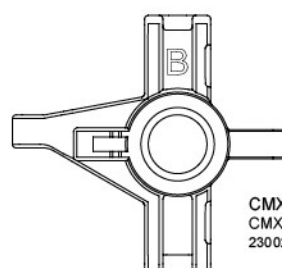

CMX Knuckle set
CMX 轉向座組
230025

PARTS

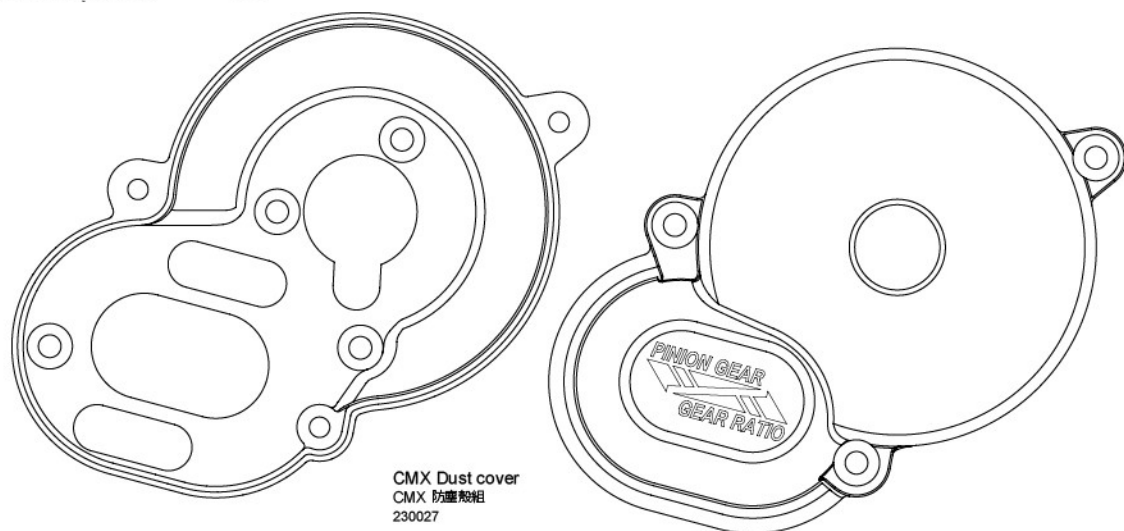

CMX Dust cover
CMX 防塵殼組
230027

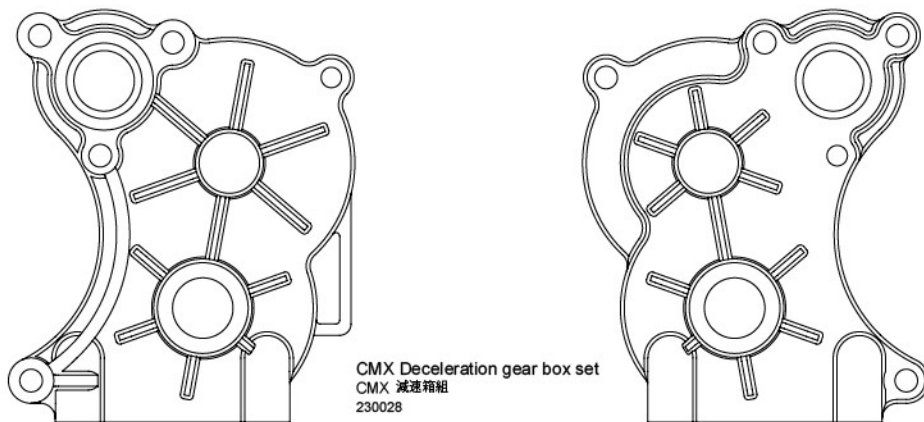

CMX Deceleration gear box set
CMX 減速箱組
230028



KM Crawler tire 30x90-1.9"
(medium-40°) x4
KM 攀岩胎 30x90-1.9" (中-40°)
831005

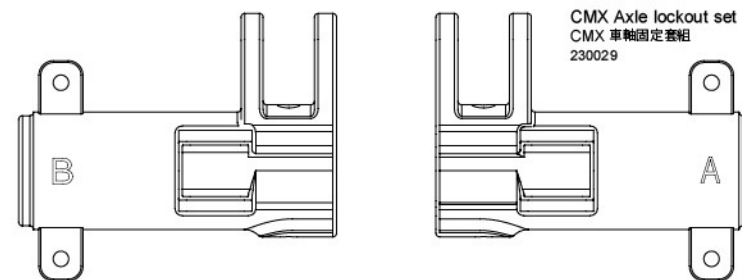

CMX Axle lockout set
CMX 車軸固定套組
230029



CMX Chassis rail x2
CMX 大樑
310075

PARTS

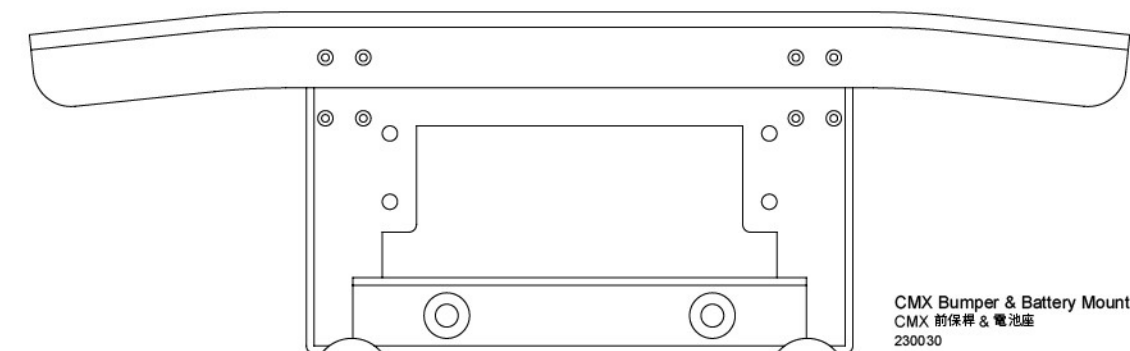

CMX Bumper & Battery Mount
CMX 前保桿 & 電池座
230030

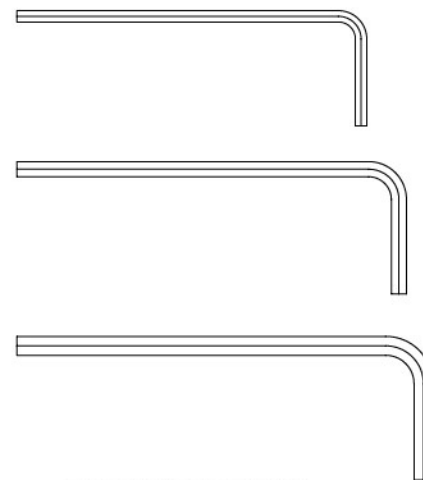
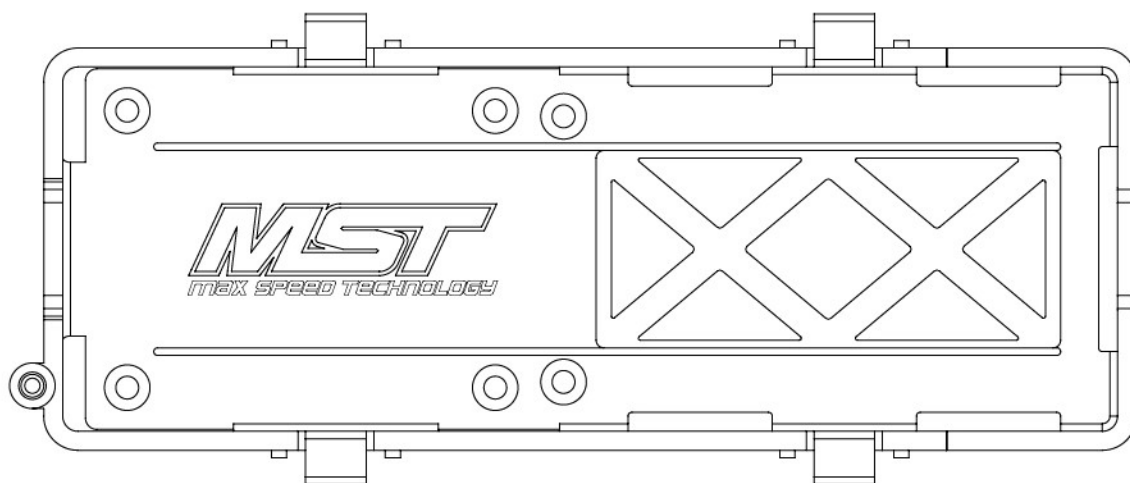

L Wrench set (1.5 & 2.0 & 2.5)
L 板手組 (1.5 & 2.0 & 2.5)
130035

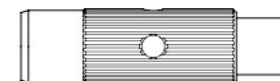

5.5 & 7.0 Alum. wrench (silver)
5.5 & 7.0 鋁合金套筒工具 (銀)
700003S

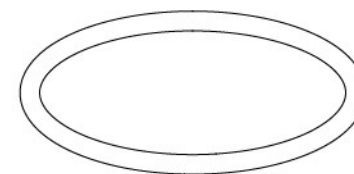

Battery O-ring (S)(2)
電池 O 環
130003

58H 1.9" Crawler wheel ×4
58H 1.9" 攀岩輪
230031 BKF

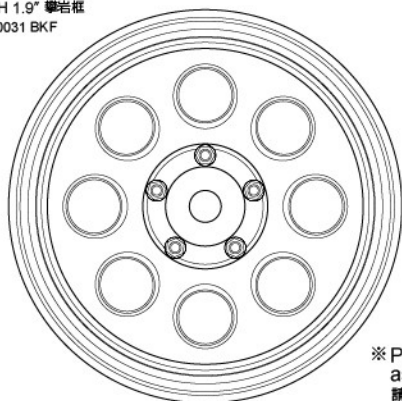

60D 1.9" Crawler wheel ×4
60D 1.9" 攀岩輪
230032 BKF

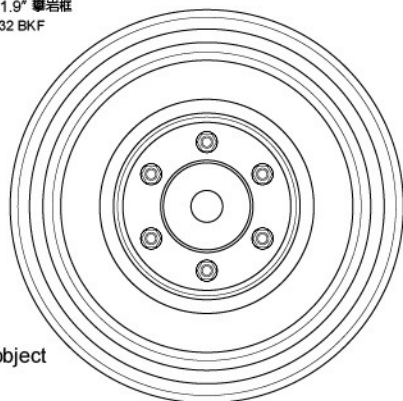

※ Please make the object
as the standard.
請以實物為主。

Spur gear 48P-88T
大直齒 48P-88T
210013

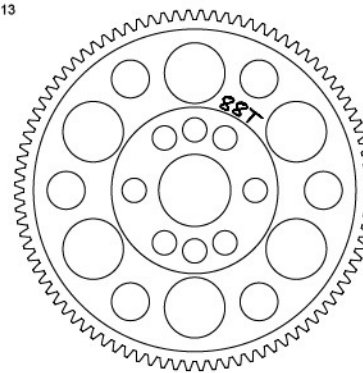

O-ring 60×1
O 環 60×1
130043

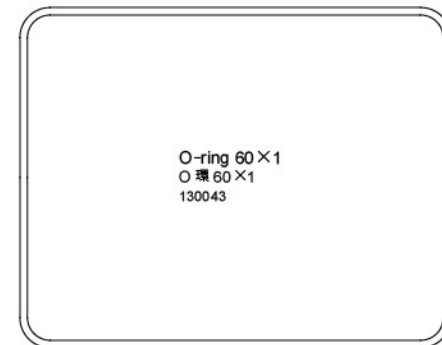

GEAR RATIO 齒比表

For 48P Spur Gear 88T

Pinion Gear 馬達齒	Spur Gear 88T
17	42.59
18	40.22
19	38.11
20	36.20
21	34.48
22	32.91
23	31.48
24	30.17
25	28.96
26	27.85
27	26.81
28	25.86
29	24.96
30	24.13
31	23.35
32	22.62
33	21.94
34	21.29
35	20.68
36	20.11
37	19.57
38	19.05

※ Please refer to MST office website for completed pinion specifications.

如須另購馬達齒，請上官網查詢！

[www.rc-mst.com]

※ Please set the gear ratio according to motor specifications, environments, and personal requirements.
齒比的選擇會因馬達規格、場地形態、車手手感，而有不同選擇。
可先參考當地配置後再選擇齒比！

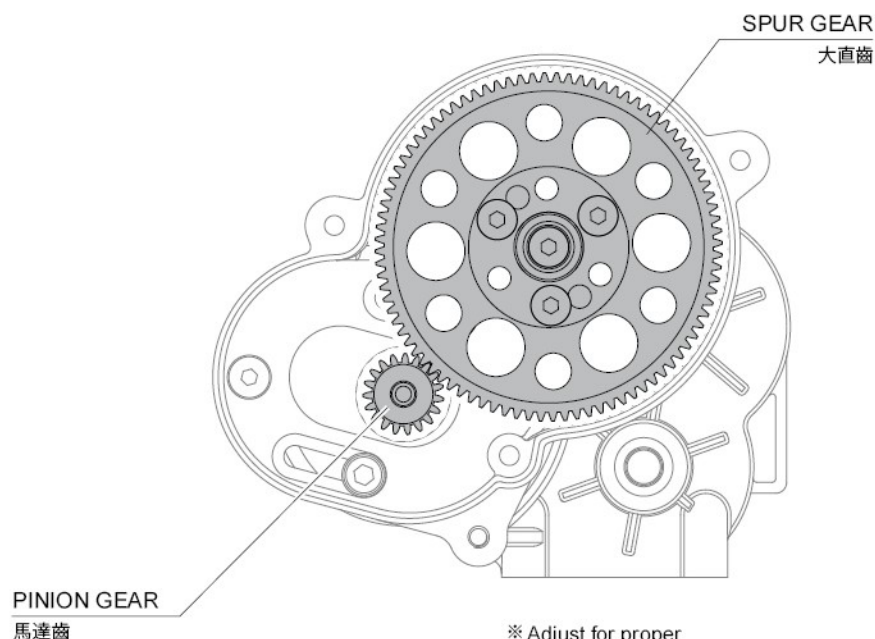

* FORMULA

計算公式

$$\left(\frac{\text{Spur gear teeth 大直齒}}{\text{Pinion gear teeth 馬達齒}} \times 8.229 \right) = \text{Gear ratio 終傳比}$$

PARTS CODE

110001 Round head screw M3×6 (10)	110061 Round head screw M3×14 (6)	130042 O-ring 3×1 (10)	230029 CMX Axle lockout set
110002 Round head screw M3×8 (10)	110073 Countersunk screw M3×16 (6)	130043 O-ring 60×1 (2)	230030 CMX Bumper & battery mount
110005 Countersunk screw M3×8 (10)	110084 Round head screw M2×10 (6)	210013 Spur gear 88T - 48P	230031 58H 1.9" Crawler wheel (4)
110009 Set screw M3×20 (6)	110085 Round head screw M2×16 (6)	210033 Servo horn set (long)(23T/25T)	230032 60D 1.9" Crawler wheel (4)
110011 Cap screw M3×6 (6)	110086 Round head screw M3×16 (6)	210057 Damper cap set	230033 CMX Heavy duty locker set
110013 E-clip 2.0 (10)	110087 Round head screw M3×18 (6)	210529 Coil spring 45mm (hard)(silver)(2)	230034 Spur gear holder
110015 Flange nut M4 (4)	110088 Round head screw M3×20 (6)	210530 Coil spring 45mm (medium)(gold)(2)	310066 Bevel gear shaft
110016 R-clip 6.0 (10)	110089 Round head screw M3×30 (6)	210531 Coil spring 45mm (soft)(red)(2)	310067 5×26.8 Shaft
110017 Shaft 2×9.8 (10)	110090 Shaft screw M4×4×12 (6)	230014 CMX deceleration gear set	310068 Gear shaft
110018 Shaft 2×13.8 (5)	110091 Cap screw M3×40 (6)	230015 Damper parts (2)	310069 Main gear shaft
110021 Lock nut M3 (5)	110092 King pin screw (4)	230016 CMX Ball connector set	310070 CVA Axle (2)
110023 Set screw M3×16 (6)	110093 Nut M3 (5)	230017 CMX Link set	310071 Solid axle
110026 Round head screw M3×10 (10)	110104 G-clip 11.0 (10)	230018 CMX Driveshaft	310072 Piston rod (4)
110031 Shaft 2×10.8 (10)	120021 Bearing 5×10×4 (4)	230019 CMX Cross member set	310073 Bevel gear set 36-15
110035 Set screw M3×3 (6)	120022 Bearing 8×12×3.5 (4)	230020 CMX Gear box chassis set	310074BK CMX Motor mount
110037 E-clip 4.0 (10)	120023 Bearing 10×15×4 (4)	230021 CMX Receiver case set	310075 CMX Chassis rail (2)
110041 Countersunk screw M3×5 (10)	130001 Damper O-ring P3 (red) (10)	230022 CMX Axle cover	310108 Wheel axle (2)
110044 Round head screw M2×6 (6)	130008 Black grease	230023 CMX Damper stay set	600002 XTR-02 2.4G Transceiver set
110047 Spacer 3×6×0.5 (8)	130017 Inner sponge (8)	230024 CMX C hub carrier set	700003S 5.5 & 7.0 Alum. wrench (silver)
110048 Spacer 3×8×0.5 (8)	130023 O-ring P3 (black) (10)	230025 CMX Knuckle set	820020 Spacer 5×7×0.3 (8)
110049 Round head screw M3×5 (10)	130032 Damper cap O-ring (10)	230026 CMX Car body post set	831005 KM Crawler tire 30×90-1.9" (medium-40°) (2)
110050 Round head screw M2×5 (6)	130034 Sponge 20×80×1 (4)	230027 CMX Dust cover	
110052 Countersunk screw M3×10 (10)	130035 L Wrench set (1.5 & 2.0 & 2.5)	230028 CMX Deceleration gear box set	

部品編號

110001 六角半圓頭螺絲 M3×6 (10)	110061 六角半圓頭螺絲 M3×14 (6)	130042 O環 3×1 (10)	230029 CMX 車軸固定套組
110002 六角半圓頭螺絲 M3×8 (10)	110073 六角沉頭螺絲 M3×16 (6)	130043 O環 60×1 (2)	230030 CMX 前保桿 & 電池座
110005 六角沉頭螺絲 M3×8 (10)	110084 六角半圓頭螺絲 M2×10 (6)	210013 大齒盤 88T - 48P	230031 58H 1.9" 攀岩框 (4)
110009 六角止付螺絲 M3×20 (6)	110085 六角半圓頭螺絲 M2×16 (6)	210033 伺服機舵片組-長 (23T/25T)	230032 60D 1.9" 攀岩框 (4)
110011 六角有頭螺絲 M3×6 (半牙) (6)	110086 六角半圓頭螺絲 M3×16 (6)	210057 避震器上下蓋組	230033 CMX 直軸連接座組
110013 E扣 2.0 (10)	110087 六角半圓頭螺絲 M3×18 (6)	210529 避震彈簧 45mm (硬)(銀)(2)	230034 齒盤座
110015 凸緣螺帽 M4 (4)	110088 六角半圓頭螺絲 M3×20 (6)	210530 避震彈簧 45mm (中)(金)(2)	310066 傘齒軸
110016 R銷 6.0 (10)	110089 六角半圓頭螺絲 M3×30 (6)	210531 避震彈簧 45mm (軟)(紅)(2)	310067 5×26.8 齒軸
110017 插銷 2×9.8 (10)	110090 銷釘螺絲 M4×4×12 (6)	230014 CMX 減速齒組	310068 輸出軸
110018 插銷 2×13.8 (5)	110091 六角有頭螺絲 M3×40 (半牙) (6)	230015 避震膠件組 (2)	310069 主齒軸
110021 防鬆螺帽 M3 (5)	110092 大王螺絲 (4)	230016 CMX 球頭組	310070 CVA 輪軸 (2)
110023 六角止付螺絲 M3×16 (6)	110093 螺帽 M3 (5)	230017 CMX 拉桿組	310071 直軸輪軸
110026 六角半圓頭螺絲 M3×10 (10)	110104 G扣 11.0 (10)	230018 CMX 傳動軸	310072 避震軸心 (4)
110031 插銷 2×10.8 (10)	120021 軸承 5×10×4 (4)	230019 CMX 橫樑組	310073 傘齒組 36-15
110035 六角止付螺絲 M3×3 (6)	120022 軸承 8×12×3.5 (4)	230020 CMX 減速箱底盤組	310074BK CMX 馬達座 (黑)
110037 E扣 4.0 (10)	120023 軸承 10×15×4 (4)	230021 CMX 接收機盒組	310075 CMX 大樑 (2)
110041 六角沉頭螺絲 M3×5 (10)	130001 阻尼器O環 P3 (紅) (10)	230022 CMX 車軸殼	310108 萬向接杯 (2)
110044 六角半圓頭螺絲 M2×6 (6)	130008 黑色油膏	230023 CMX 避震架組	600002 XTR-02 2.4G 遙控器組
110047 墊片 3×6×0.5 (8)	130017 吸震泡棉 (8)	230024 CMX 轉向C座組	700003S 5.5 & 7.0 鋁合金套筒工具 (銀)
110048 墊片 3×8×0.5 (8)	130023 O環 P3 (黑) (10)	230025 CMX 轉向座組	820020 墊片 5×7×0.3 (8)
110049 六角半圓頭螺絲 M3×5 (10)	130032 避震上蓋O環 (10)	230026 CMX 車殼支柱組	831005 KM 攀岩胎 30×90-1.9" (中-40°) (2)
110050 六角半圓頭螺絲 M2×5 (6)	130034 吸震泡棉 20×80×1 (4)	230027 CMX 防塵殼組	
110052 六角沉頭螺絲 M3×10 (10)	130035 L 板手組 (1.5 & 2.0 & 2.5)	230028 CMX 減速箱組	



WWW.RC-MST.COM
[facebook.com/MST.tw]



Max Speed Technology

